

## PRODUCT DESCRIPTION

StraightLine SEG display systems feature convenient tool-free assembly, durable light-weight frames, and silicone-edge graphics printed on exclusive One Planet recycled fabrics with impressive vivid graphics, all conveniently organized within molded inserts in a heavy-duty shipping case. Panel A1 features a striking slanted design that stands out on its own yet also serves as a dynamic accent when paired with other panels.

Upgrade to double-sided graphics, mix-and-match with other StraightLine panels, or combine with WaveLine and BrightLine displays, to create unique branded environments. Counters and other accessories complete an enhanced experience to help brands stand out.

## KEY FEATURES

- Modular system
- Easy tool free assembly
- Lightweight portable construction
- Heavy duty shipping case, molded foam inserts
- Single- or double-sided
- Vibrant graphics on recycled fabric

## GRAPHIC MATERIAL

Graphic Print :  
Dye sublimated on One Planet, 100% recycled, fabric

Bottles recycled  
**42**

## GRAPHIC FINISHING

Silicone sewn edges

## WARRANTY

Limited Warranty Periods  
- Frame : Lifetime  
- Graphics : 30 days

## DISPLAY CONSTRUCTION

Aluminum frame with aluminum support poles

## DIMENSIONS

|                |                              |
|----------------|------------------------------|
| Assembled Unit | 60-70"w x 96"h x 4"d         |
| Packed Case    | 46.5"w x 15"h x 12"d, 45 lbs |
| Shipping Box   | 47"w x 16"h x 13"d, 47 lbs   |
| Graphic Size   | 60-70"w x 96"h               |



## PARTS

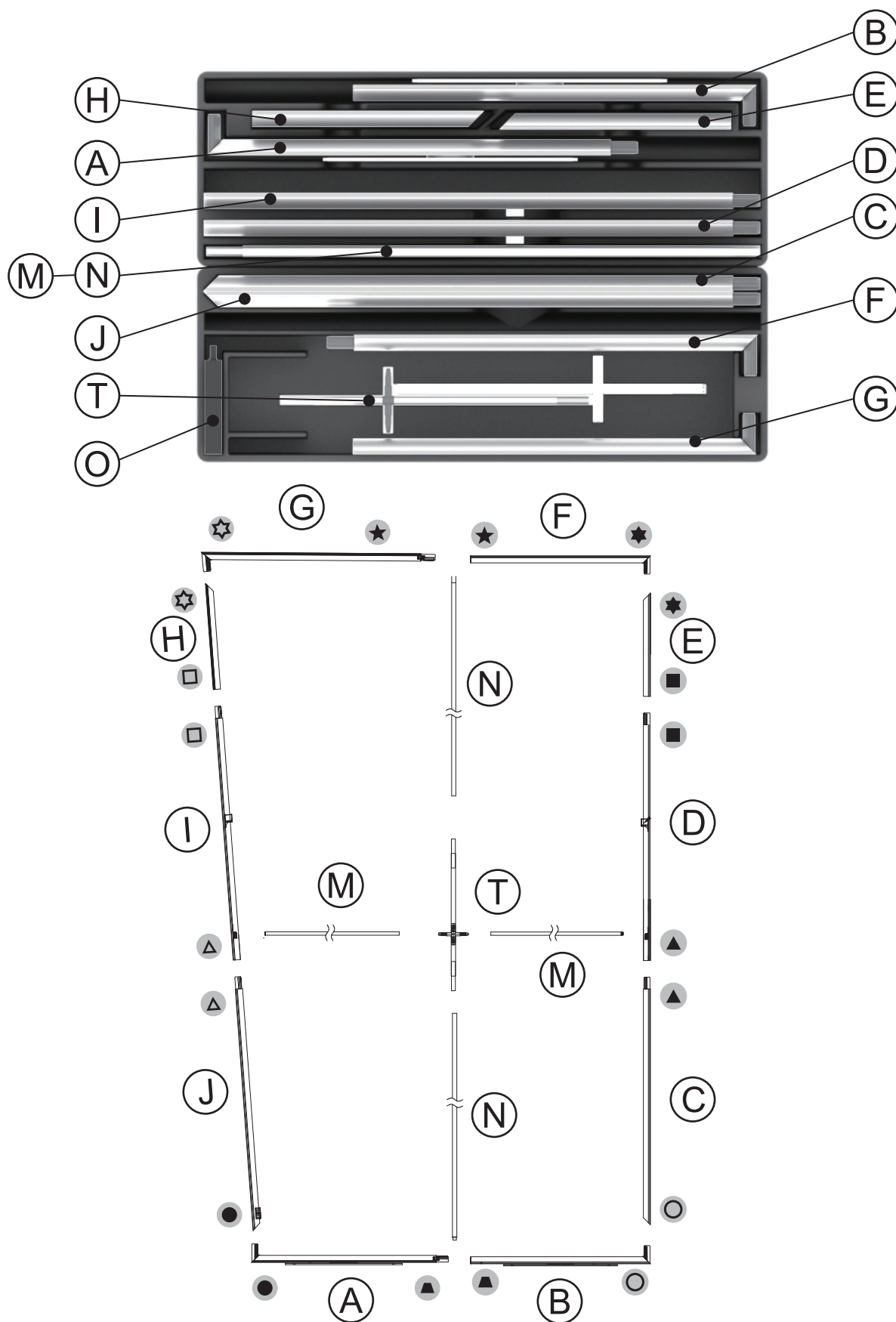



## ASSEMBLY

Assemble parts on the floor and stand-up unit when completed.

1

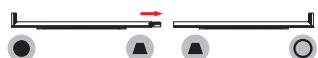
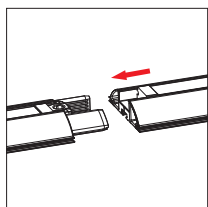

2

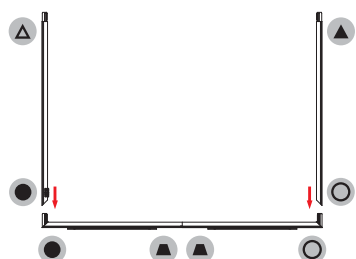
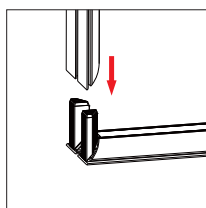

3

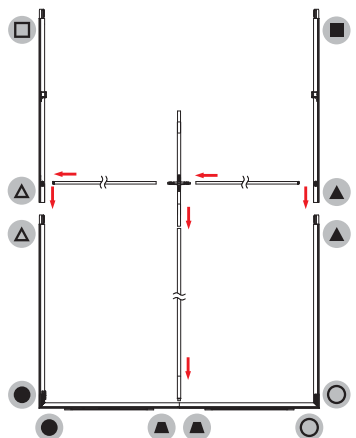
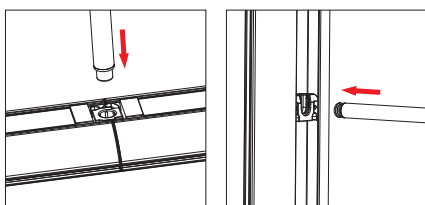

4

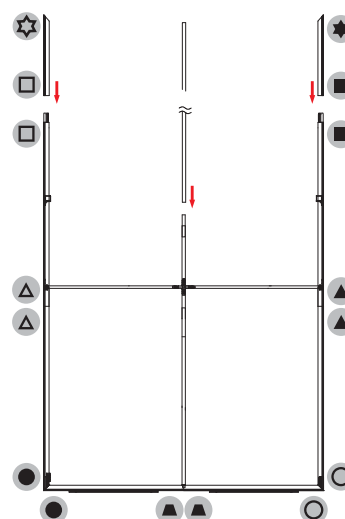
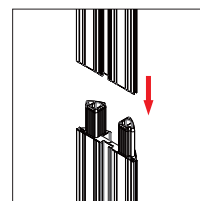

5

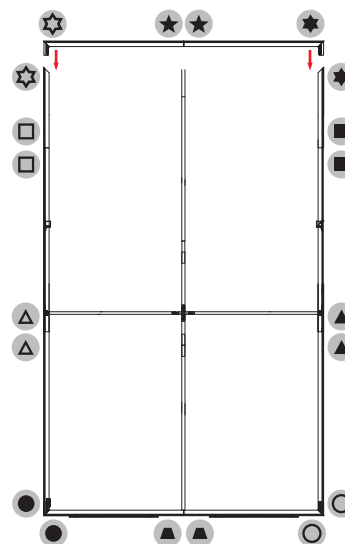
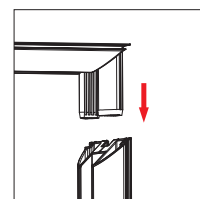



- 5 Push the silicone bead into each corner of the frame with your thumb.

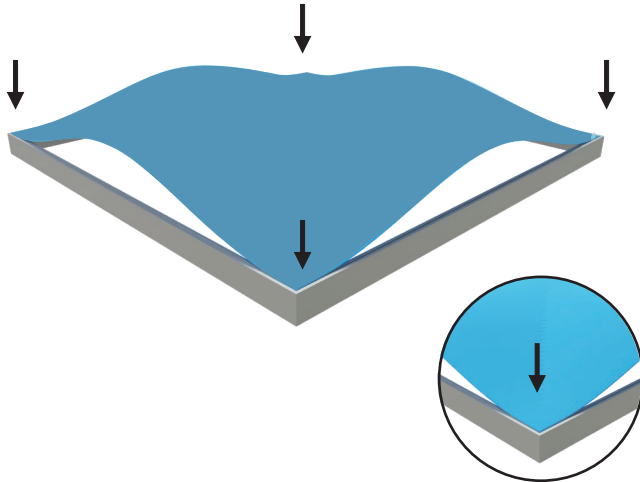

Push the silicone bead into the middle of the run and work your way around the perimeter of the frame until all beading is pushed in properly

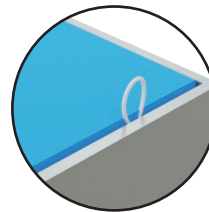
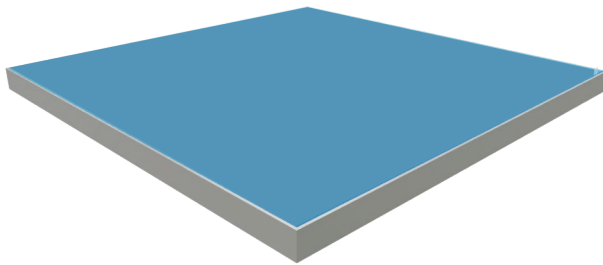
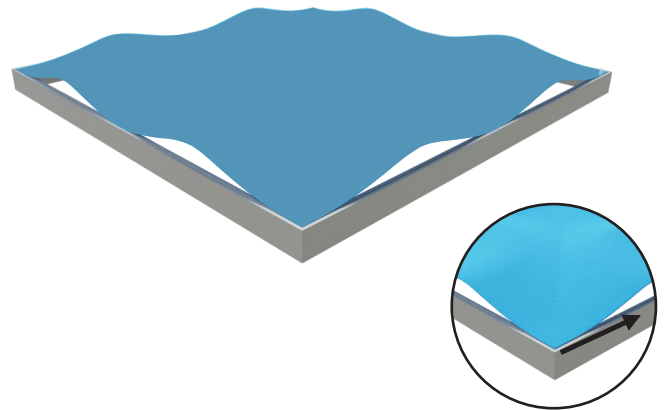

## To Remove Graphic

Use the pull tab located on the graphic and gently pull the graphic from the frame, going around the perimeter

- 6

